

Kelp

Kelp beds

low tide

here fine gravel

beach

beach

Creek

Rock

logs

we built nest

nest

Waterfall

W. H. H?

39

38

LE

36

35

34

33

32

31

30

29

28

27

26

25

24

23

22

21

20

19

18

17

15

14

12

11

10

9

8

7

6

5

4

3

quarry

box

etc. into

etc. into

etc. into

etc. into

etc. into

etc. into

etc. into

etc. into

etc. into

etc. into

etc. into

etc. into

etc. into

etc. into

etc. into

etc. into

etc. into

etc. into

etc. into

etc. into

Happle

Happle

Happle

Happle

Happle

Happle

Happle

Happle

Happle

Happle

Happle

Happle

Happle

Happle

Happle

Happle

Happle

Happle

Happle

Happle

Happle

Happle

Happle

Happle

Happle

Happle

Happle

Happle

Happle

Happle

Happle

Happle

Happle

Notes on Akedans
West to East

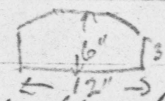
At the extreme west end, just west of little creek is wreckage of a little house, only 15' wide. Side uprights are 6' x 12", front top plates are 15" x 3 1/2", with a 1 1/2" groove in bottom edges. Notch in side uprights is 4 1/2" above ground. Rafters are . Use unknown, although a row of skulls lies a few yards west on ground, put there by visitors. Nothing salvagable.

1. On other side of creek is the wreckage of some kind of grave house? or box? A very old frontal pole has fallen on its face here, and a few feet to left of it is a bin or box containing many bones.

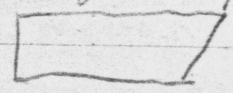
The front plank has fallen forward on its face but is plain. It is  5" x 2' 11" x 8' 8". The side and back planks are also 5" thick, sides about 6' long x 12" wide, back about 7' long x 14" wide. Box has been roofed, but most of roof gone.

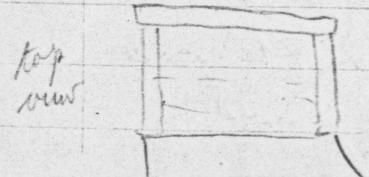

2. Fine standing frontal pole. Roughly pole of left hand side is in good condition all the way up. R H side has weathered some. Pole 36-37" wide at base, 18" thick. Height estimated 32'. From bottom up: Roughly bear with protruding tongue. Whale down pole with man squid down back. Small man with animal ears. Raven, beak down. Eagle. 2 with men with little whale. Beta. Back hollowed. This whole pole is definitely salvagable.

The wreckage of the house is almost completely gone.

3. Parts of wreckage of old house lies on ground. Frontal pole has fallen obliquely toward 2 a part of it rests over roots, off ground. The base figure (?) a crouched man, lies in front of house, cut square across the top by saw. It is 3' 5" wide, 7' long. Down to the elbows it is still fairly sound and can be salvaged. A fine piece of carving. A section on lower leg is missing.

A section above this has been sawn out and removed. The rest lies on its side over roots of trees, and parts are sound enough.

To salvage. From saw cut (which passes
6" below eyes of a large figure). a
middle human (animal-eared face 2'6" high
between side fins - figure below must
be a whale. Then a large crouched animal
creature holding a small man - man's face
where animal's teeth should be.

Top 3 watchmen are gone - had 4 rings.

18' of this carving could be salvaged, and it
is excellent work.

A front upper plate of this house is
2'6" wide, 5 1/2' thick. Bottom edge has 1 1/2" x 1 1/2"
groove to receive front wall planks.

House was 33' ^{wide} between ^{long} back posts, 26' front
to back.

4 House was excavated

The large beam (round) is 44' long, 15" → 24"
diam. An upright post is 10'6" high,
2'5" wide, half round (hollowed back), dished
at top to take beam. Centre excavation
is 27 x 27', walled with thick planks
2' wide. Floor is about 4 1/2' below present
ground level. There is a large round
mound in centre.

15' in front of the front of excavation
is a long log or sill across what was pro-
bably the whole front of the house, 50 feet

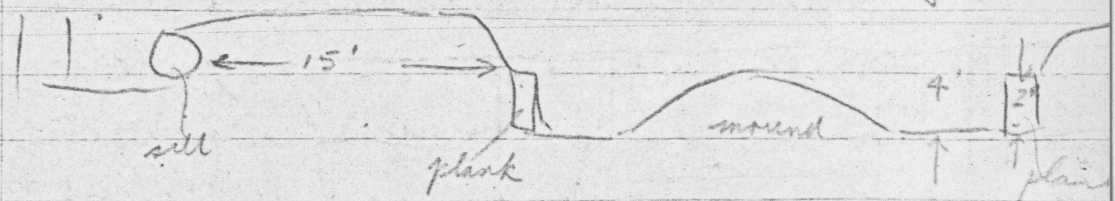

No other house timbers except 2 beams remain.
Standing 4' in front of sill was a tall post
a single figure - a toothed whale? or bear
at base, about 8-9' high, with a huge
rectangular dorsal fin, 14" wide x 33" deep at
his head, tapering to 8" x 24" 56 feet higher.
This, now lies shattered on ground, none
salvageable except part of side of face
bear which is down.

Lying in front with 2 trees growing on
is a very old figure of a bear or animal
(a horizontal figure) 10' long x 4' wide.
Can't see any carving, just shape.

5 There was a fourth house in this row
but all that shows is the dim outline
and the completely decayed remains of a
frontal post.

6 In front of this old house by 25 feet stand 2 mort. columns. No 6 is a double one.
 2. 2 1/2' diam poles 2 1/2' apart. 24 feet high.
 set.

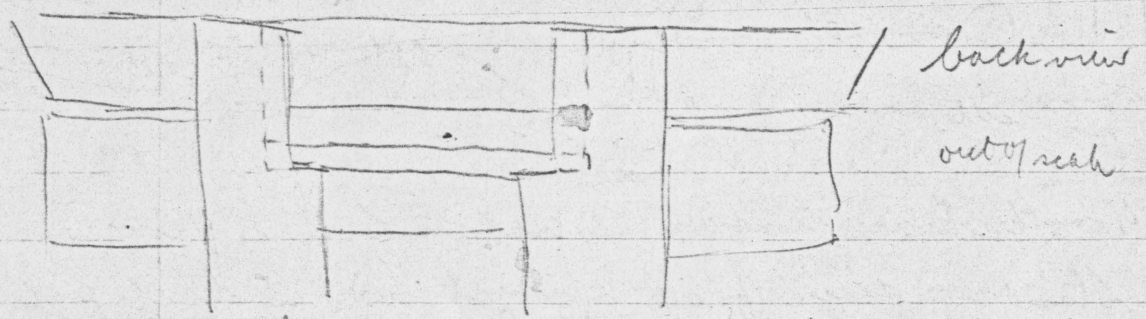

In front board is dogfish like our model in
 Museum.
 Prob the orig.

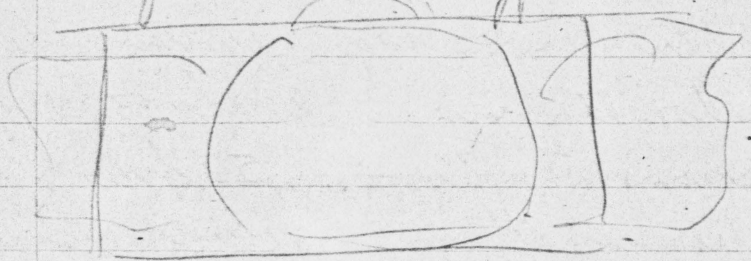

7 Plain Mort pole, slightly smaller than each
 of double posts beside it.

8 There was a small house whose RF corner post stands
 right beside No. 7. Nothing else remains. But in
 front of it, now fallen backwards, were 2
 mort poles, 8 & 9.

small parts
 subscripts

No 8 was a big one, curved completely.
 Figures can't be made out except ^{one of} top row
 of little humans 3' tall just below box part

9 Mort post also carved. Top large fig is Eagle
 - best gone
 - Creek.

10 Wreckage of former house facing bay at angle to
 previous line. Wreckage of frontal pole in ground.
 Nothing can be made out or measured.

11 Plain mort pole on back. Stood 30' in front of
 house 10. 3'6" diam at top. Was 20' high and
 3'6" in ground. Diam. at base was 2'10".
 Hollow in top 4' deep (top to bottom, 2'2" wide
 18" front to back. Top and bottom boards
 are 1 1/2" x 9" x 7'6". Nailed on with big spikes.
 Center board missing.

12 Plain mort pole on ground rotting. Same size
 approx as 11.

13 House with some timbers standing. Fallen frontal
 pole extends out over beach. Front cor posts are 4'
 apart. One is 19" diam. That starts 7'6" above ground.

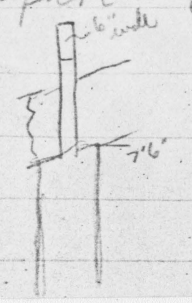

Back post is 39' behind front one.
 House is use only enough to level
 floor. Back RF center support is
 a timber 24" wide x 11"

Sunday Aug 16

Got out at 6:30 AM. Very cloudy drizzle morning. After breakfast walked to Shedano & return. Hard climbing. Couldn't cross it when I got there. Back at 10:40, raining.

Spent the day axing out lumber to ideas for shots if I ever get any light! Also began taking notes on the remains, house construction, etc. At 6:pm a really loud storm blew in. Still blowing, sheets of rain. My feet are getting sore from being continually wet. Cloth shoes weren't made for this place - walk 3 steps in the grass and your feet are wet. No bears at all today - here or on way to Shesano Creek. Turning in early.

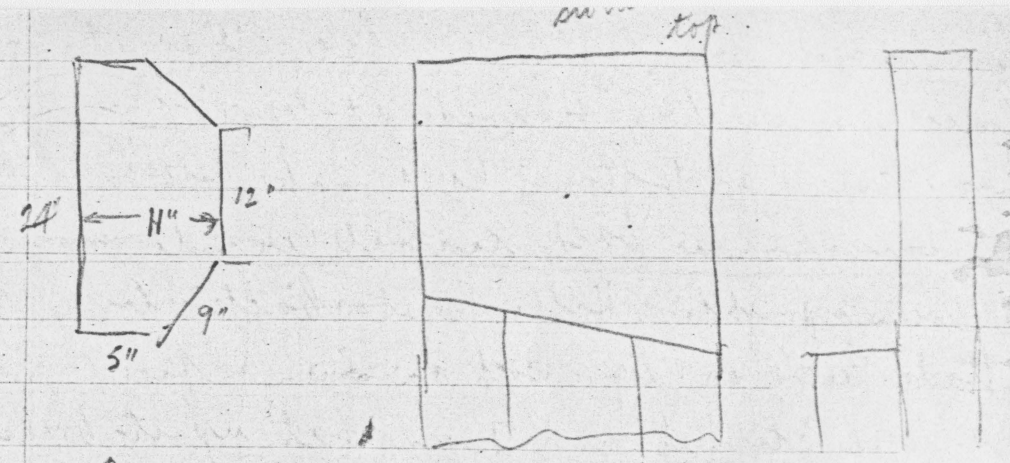

Front central supports are a little bigger, 28" diameter. They were planted 4'6" apart, which is greatest width of frontal pole at base. Pole has no door hole. Slot in back of upright starts 12' above ground. Front plate is 32" x 5 1/2" with a 1 1/2" wide x 2" deep groove for front boards down middle. Spindles set cut at angle at ridge.

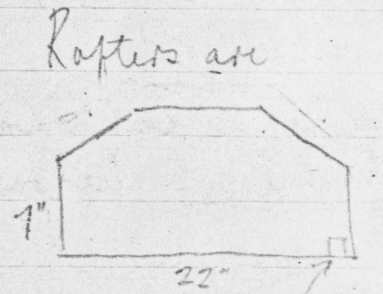
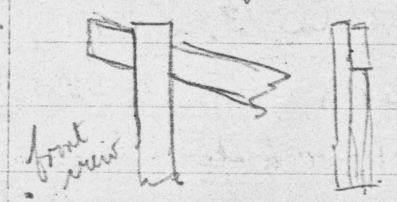
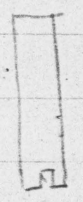

Rafters are projected 3' beyond plate at front. Outer rafter has groove to take side boards. Large ends of rafters to front of house. All timbers smoothly adged with elbow adge. Can see adge marks.

small parts salvagable

Frontal pole has fallen on face. Was at least 45' high, 4'6" wide at base

Large Beaver at bottom. Cant make others out. House had a back central inside horizontal between uprights. Hollowed at back like frontal. Had Eagle on top with an - man face between its feet and 7' high hat up its breast. Bottom was whole. Was 15'6" high.

14 Was an old house directly behind 13. All that remains is wreckage of frontal pole on face - rotted. Not excav. but area can be seen

15 Wreckage of house. Smaller than 13, some timbers, but immeasurable. Frontal pole lies on face, Door hole 4'6" wide at base. Big beaver at base. Big Dogfish above. Cant see top, but 3 watchmen

16 Most pole. Big beaver at top. ^{holding seal} Bones in. Bottom 7' plain like copper's inscribed. Not salvagable.

17 Large excavation of old house

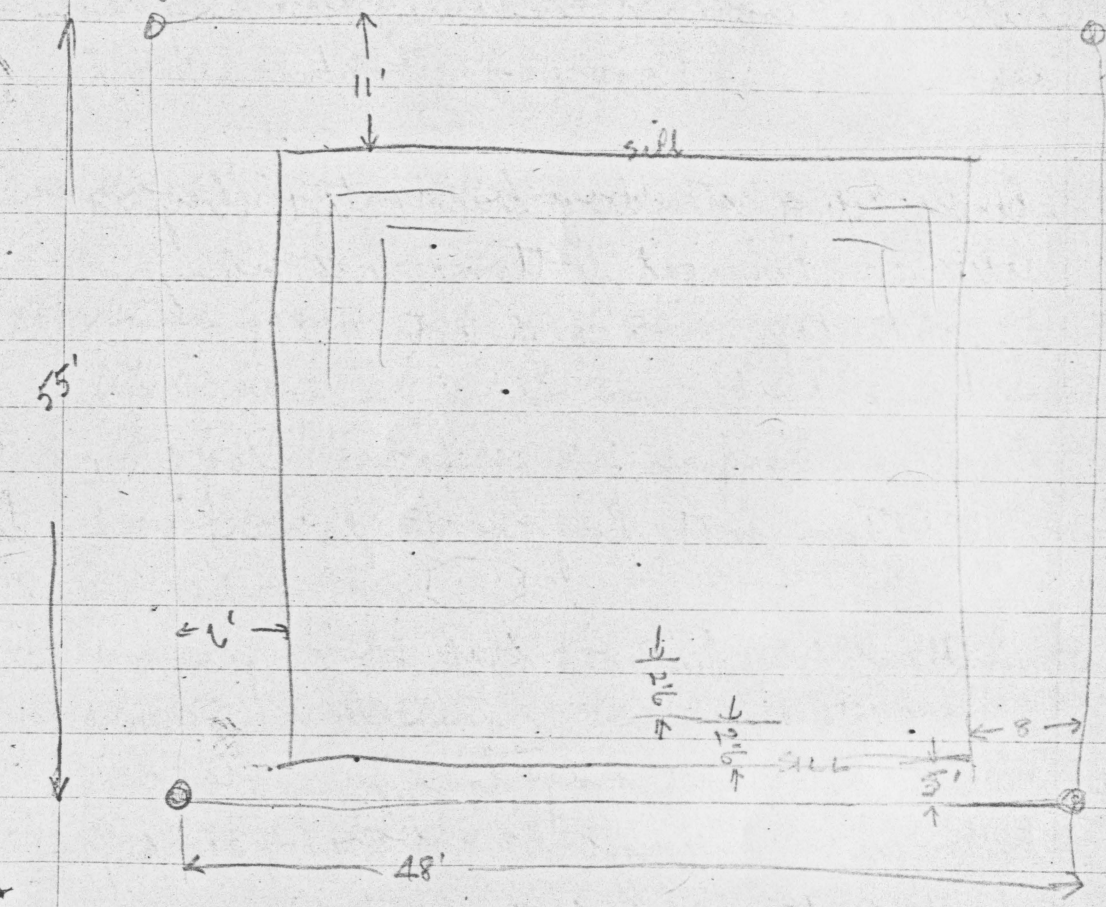

Central pit is 24' back-front, 27' wide, and is 9' from ground. Sill all around, then down in 2 steps to bottom pit. Steps faced with timbers on inner side.

part of double pole

In front of house are 2 plain most poles. one up, one down, faces gone. Nothing salvageable

18 Beaver Pole - standing but rotted beyond salvage. Beaver at bottom with many rings to top. 45' high est.

19 Shattered Dogfish pole on face. Dogfish at bottom with long ~~rest~~ dorsal fin.  Must have been 50' high. Small parts salvageable

20 Beaver Pole with rings to top. Standing. Thinner than most - 2'6" base 36' high? Badly rotted. Root couldn't recover any.

21 Space of former house. Nothing remains.

22 Wreckage of small house. One sifter only 24' long. Back excav. into bank, front not excav.

23 Fallen Most pole. All carved but figures can't be made out. Was 24' up to box, 29' all together. 3'10" diam at top (by end).

24 Wreckage of small house.

25 Standing most pole with tree growing up front. Whole down pole at bottom, little man face at top. Top piece on, carved oval face, but very badly weathered.

26 Remains of double most pole. One half down, other almost. Nothing. Plain posts.

27 House & frontal wreckage - Nothing.

28 Standing plain Most pole. Flute adze part way.
 
 By one - 4' diam.

29 Fallen big Mort column. Too far gone
Was Man riding on big whale down
pole Was 21' carved + 5 on top. 3'3 diam

30 Wreckage of small house ~~33' wide~~ ?
31 " " house.

32 Stand Mort Col. Eagle over whale
Somewhat smaller than most Badly gone.

33 Stand, Plain Mort Post. Nothing

34 Standing Mort Post Large eagle starting
4' up, with man on breast and betw
ears.
Lee half could be salvaged. Back gone

35 Wreckage of house and frontal pole
Whale on bottom. Door hole.

36 Wr. of one house

37 Leaning Mort pole Knelling Buggy at top
over whale. (Inwar. pic) Lee side could
saved

38 House wreckage. Back see into bank

39 House site.

40 H F Pole leaning ^{sideway} in tree. Whole under side
could be saved. Butt is Buggy over door
hole. Lge Man with sm man betw knees
Eagle holding seal. 3 watchmen
Fine carving.

Summary of Skedans.

- 1 standing Frontal pole (Buggy) fine carving, all salvagable
 - 1 Frontal pole leaning in tree - all on side salvagable
 - 1 Frontal pole ^{large} parts salvagable, lying on ground.
 - 2 Mort poles, lee half mostly salvagable
- Several small sections of details of carvings can
be salvaged, given a free hand with a saw
and a crew of men

old house site half moon



20 hours



TANOO

Saves - North to South

- 1 Grizzly bear house. House ^{is} ruins but good frontal pole. (See barbara) bottom: S.B with man betw claws, Large Raven with feathered man betw knees, Large Eagle (beak gone) w. little man betw. knees, 3 watchmen. This pole is in fairly good shape, could be salvaged in one piece. Watchman's hats part gone, Eagles beak too, rest good. eye base sitting 3' up. 3'6 wide at base 42' high est. House 32' wide, 30' deep Not excavated

- 2 Wreckage of house. Enough stands to give approx size: 36' x 36'

- 3 BEAVER HOUSE - Frontal pole and whole framework standing. Pole has large Beaver at bottom, with 5 rings hat up chest of long haired Man, then Eagle, then 3 watchmen. All in amazingly sound shape, even a little red paint on B's lips, thick. 3' wide at base. Est 35' high. Could definitely be salvaged, only a little rotten at base, best pole yet as far as condition goes. Carving not quite as fine as older poles, but still good Haida.

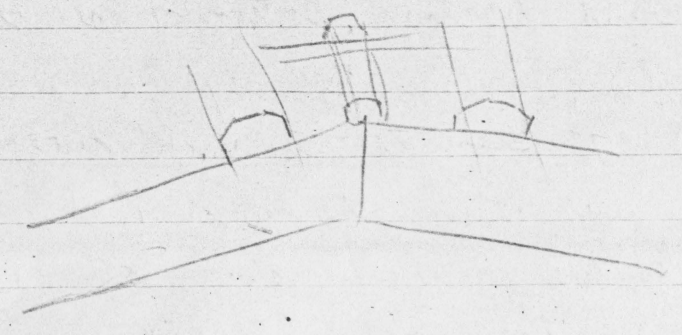
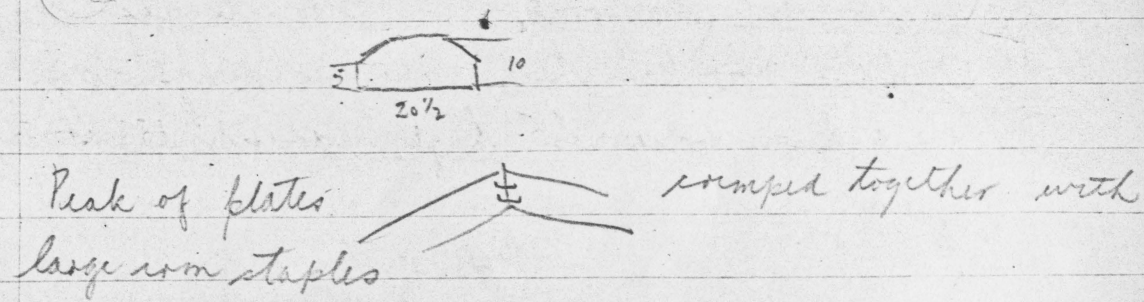
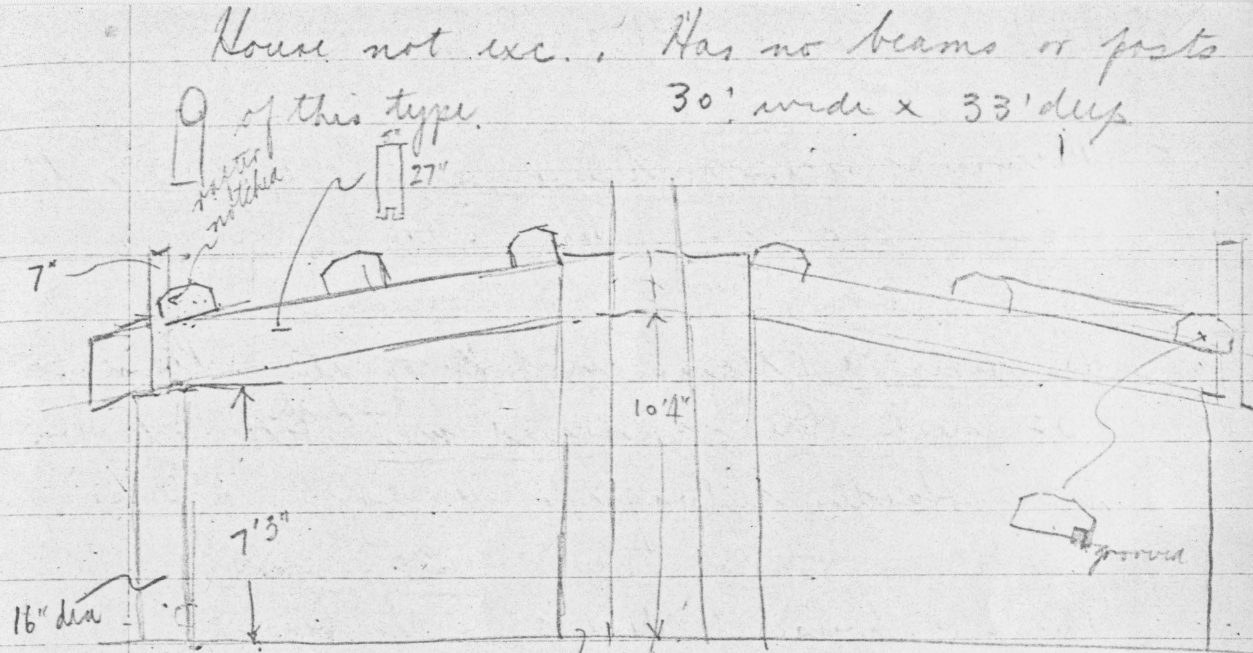

4 Wreckage of house 31' deep Not exc

5 Wreckage of excavated house, somewhat larger than 3 & 4. Exc 3-4' deep

Has Mem pole leaning in front of it. Plain pole 32' high. One fig, seated man ^{4' high} with hat, on top. Hardly salvagable

6 Ruins of house N. exc No beams

7 " " " Not exc.

Fallen pole in front. Single fig Beaver at base, broken here, with rings up pole. Pole 3' diam base, 65' high, round 13" at top.

8 Large house ruin on ^{10'} rear back of others, Excavated. Had big round beams. Bottom of one is 9' above ground level at front. One is 3' diam at front, 47" long, 27" diam at top, fluted adged. Back post supporting it was rect. 40" x 15"

Middle excavn is 25'6" deep, 22'3" wide faced by a 30" wide x 6" plank. Then 3'6" shelf, and step faced by similar plank

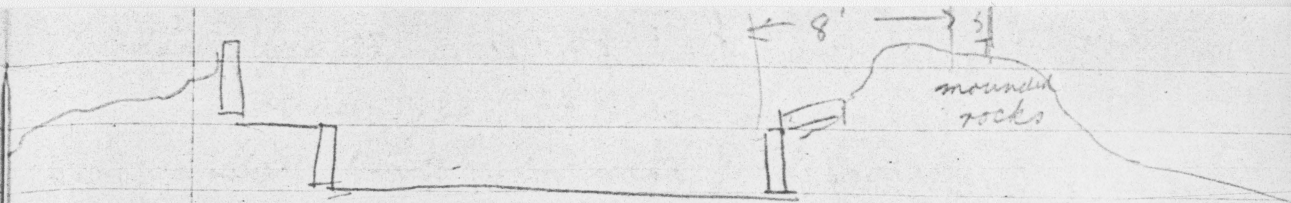

9 House ruin. No ~~posts~~ ^{beams} Not exc

10 " " Excavated. Had round beams

11 " " Not exc No beams

12 " " " "

Weeping Totem house frontal, no door hole 4' wide at base 37' high. Large Whale a base, Man, Weeping woman holding frog, Owl face, ? Top badly rotted. Whole pole badly rotted esp on weather side. Could be moved in one piece. Could salvage top of whole, for man, weeping woman (centre section only of whole pole)

13 House ruin, Not exc, No beams

14 ditto

15 Remnants of 2 large Mast posts on ground

16 Standing pole 30' high Plain exc for 1 fig at top: Whale with tail on mouth. Back of head has hollow, with soon something showing out. Rem. of Thunderbird on ground may have fallen off top

17 Standing Mort. Bad shape. Lge Eagle?
with man face on front.
House remains, excav slightly. Round beams.
Not large.

18 Wreckage of large excavated house, Rd beams

19 " house. Not exc

Mort pole standing, but badly rotted and
obscured by tree up front.

20 Last house. Not exc.

Summary of Totos

3 frontal poles stand:

1 Grizzly - fine pole, could nearly all be salvaged

2 Beaver - good pole, " all be salvaged, soundest of all

3 Weeping pole, fine carving, but parts only could be salv.

2 single figure Memorial poles stand

1 Man on top - could poss be salvaged

2 Whale on top. " " " "

1 Mem. pole on ground: Beaver - part of head could
poss be salvaged

2 Mort poles stand - nothing could be salvaged.

Sunday, Aug 23

Got up 7:30. A fine day.

Shot 1 roll color with Jack Bishop's camera, for us
Shot 100 ft movies:

- view of beach

- retake of Grizzly pole

- series of closeups of eyes, faces, etc.

"They start out, ^{im}impassive (one crying) patients
as they slowly weather away"

Finished shooting by 10:30. Waiting for boat.

Boat did not arrive. Became overcast in
afternoon and rained lightly in early evening.
Explored, dug some clams and ate them, lay
in sun, and generally passed the time. I
divided my food up into 6 "days". Surely
someone will be along by next Saturday.

Dull in evening, light rain in night.

Louise Collison is best carver

Kingdom of the Sun by Bertrand ~~Leacock~~ ^{St. Clair}
is fine book on Haida.

Miss Stevens doesn't think there would be much difficulty over completing claims of ownership. The people here are reasonable. Thanks something should be given to the owners, even just the job of putting them on the boat.

Jimmy Jones: Skidegate. "Over 70" born at Tanoo

Village in 2 parts { t' a n u "eel grass" - name of south side where sandy beach is

g a o o | c i o d i s - north side of village

' p u c h | s t r a n d t h e m u p - stranded little perch on beach

Two kind of diff sides - Eagle side was south - tribe called h a s k i g o s "Eagle". Chief lived here g e t k u i n , also called x' i i "south wind."

He was chief of the village.
x' u' y a - Ravens lived on other side.

Buzzly Pole - at end of village. J remembers no house there, just the frame when he was a kid. Not sure who owns it, may have been his uncle's.

Beaver Pole - no living descendants.

Weeping Pole - no claimants

Nathan Young now chief Kithin, but doesn't know anything about it. Who Cimeh... a loosing.

Some people = Young people

Madison Young

Mary Anne

also some younger people who don't know

about how to help to Madras - an acceptable letter

xi:at - round pit - Madras - secondary too

g'a'gay - real temple - some forest

also made pits

Church Creek - some people moved there when g'at a 20 - back at Church Cr

Catalan was name of valley across Chankhura

houses were all along sandy bank Church in middle. House built and brought here. Church left.

Also Madras & Madras people moved there. Movement was from _____, an Indian from here. Other followed

House is up. was g'a' real muck's house - g'ao ay

There an old. Nakh Calder g'a'k'a'3 ain

He "threw it away" and built No 8 later for it

when g' was a little bit

anything you still own

Army - apillar spirit/panda house in palace pig

7 was g'a' father's in Eagle. House in father's

Madras. But there boy man who took his

House: back Monday from Madras, moved

to town. Charles g'ome m'i'a'ba'ka'a

9. was for younger too. Paul g'ome

g'a'm'a'a - also g'a'g'waya - a

madras/Madras. He accepts

about g'ome

Big back see. house - was for muck's house

g'a'm'a'a - just a hole in his memory

6 Mary Anne's father's house

5

g'a' muck's house. Recreated Edward Calder

- 4 Old house, old fellow. doesn't remember name
- 3 Beaver house - not related. doesn't remember name.
- 12 Benjamin Starr. Mary Davis' uncle - Weeping Pole
- 18 Ecc house was Bethun's house. Used to have big sun porch in front.
- 14 George Green. Mathew Williams' uncle. New house.

2 beam house was old style
6 " " " " new "

X d s n x a d a x a Mainland people
outside people

y a k w e x a s - his bro, g d n d l a s ^{took his} slave

w a w y a l a - chief from Bella Bella
Peace came when Y a p w e d l a s came in 10 canoes, traded gwandles' da for his bro.

Prophet was fa's uncle.

Susan Williams - ^{Mrs} Miss Jones' granny
Johnny Wms her husb was a chief Gitksan

X u in canoe

Luke Waterin } carved in wood, but now dead
Thomas Moody }

Spent 10-12 with Sol Wilson

12-2 " Ed Stevens

2-30-4:30 " Jimmy Jones

Rained pretty well all day. In evening, asked Charlie Kaste if I could borrow his skiff to visit Lina and Maude Islands

Susan Wellesons & JJ.

Older than JJ. Born Cumsh but uncle was Chief Skedans.

Skedans:

q'u'na - name of village

t'i'sk'ana ya

n'a'n t'on λ e y u w o n s "something big going along"

g'i d a' n s t o - no meaning

h'u'azi

g'u'y

3 names of chief: Chief used Grizzly Bear, Moon Mtn Goat, Killer Whale ^{Finback} s'a'ina
m a D

as has 4 crests (g'a'g'a)

Quite a few people in village belong to Skedans.

~~g'a'g'a~~

R+

g'a'g'e'l's g'i'saway family

Henry Moody (in Cumshwa pic) was her brother.

Now Mrs W is chief of Skedans

Mrs JJ is her daughter. Mrs W had a big family - 4 sons as well.

Albert Jones - also Skedans.

Mrs Tait - also has big family

Grizzly House at end. No white man name

2 g'a'yew's house
no living descendants

3 ~~s'a'ina~~ s'a'ina s'a'ina house

Eagle = g'u'D

R+

Raven (huyi')

g'a'g'e'l's g'i'saway

Point

"Little Cumshwa" Raven R+ (also)
t'kin w't' lina s

vill chief lives here. his family had 4 crests named on other page.

Grizzly
Moon
Mtn goat
Killer whale

E3
Laskigoo
Eagle
g'u'na g'i'saway
there born at Skedans

4 crests:

Eagle g'u'D

Beaver 'ci'y' t'ci

Raven

Dogfish g'a'x'a'o'a

2 crests

Grizzly

Finback

None at all of *qunaqiraway* are living.
 Nathan Young, *betken* now, is not really in
 this family, but closely related.

This family was highest on QCI, The first
betken was this family, from *Shedans*.

Lady, a queen *zi lak'wana*, from
 mainland (now lives at lake at head of
Cumchewa) came by. One of gods from
 her land married a man at *Shedans*.
 Her children became *qunaqirawa*.

k'i'wax'lanas - a few families left. Close
 to centre group. Albert Jones, etc. Quite a
 few.

End house (leaning pole), was *ka'las*
 No descendants left.

Hours of ^{means} ~~Cumchewa~~ *Shedans*

1 *ka'las*

xidok'in'oldanas
 little trees bark cutting off - house of
 House name $\frac{2}{3}$

2 *zi'dana*

- name of house?

3 *nongayki'ldagay?e'wana*

boomerang around head in the water

the Chief of
k'i'wax'lanas

4 house empty in her youth.

House *kuozax'xi*
 grizzly bears mouth.

5 *wadanas* - man's name.

6 *yax'gwas* - man's name. *k'awga'n'ya*
 his uncle when he was young
na'aw'ya - house name 'mother of all houses'.

7 Chief's house. Have his names
sing'an'ay "winter's house"
 Also her uncle.

8 Next one was *uxar*. (called *da'ya*)
qud'ay'dax'xi'gans - house
 blowing clouds making noise on the house
 Also belonged to chief. Have stayed in it.

~~Now in Laskigla part of village~~

9 na q'a'xans - "the house that is standing"

hasgiogunga

dog's name was
basket

father of

st'ile "cliff"

his by name

nickname

10 ku'nas "whale house"

Don't know name of owner, but kunaki's away.

7 ~~2~~

sig'ig'ila had 2 houses on other side of creek.

Then another house with da'a - also belongs to Chief Skedans ku'nas - Moon House

ki'ig'ila's house - Her mo's bro another seal uncle.

ix'a'ia'ia "something wrong" tried to put up a pole with 3 ladders on it 4 times it fell down. She didn't like it. So left it lying. The old house was gone before her

time. ~~2~~

End houses were too old. She doesn't remember

Mrs Tait's family as ^{most} closely related to Ganew's
Gygyly Pole

Ganew's pole is at Rupert

Alens " " " Rupert too

Send Mrs W and JJ "Totem Poles" V.2.

CUMSHEWA

k'ic'nal - no meaning

k'al't'iza - chief's name - Cumshewa

q'u'inas "My House" his house

Story of a Capt Cumshewa, of boat scho Whites came to village. Chief looked like Capt Cumshe. Tested him by offering 2 overcoats 1 thin expensive, 1 thick. Took thick as Ind - gave him name Cumshewa.

All Eagle tribes
from ži la'k' on. All one big
family, not 3 as in Skidans.

~~Notes:~~

ž i' d a n a s chief's house
"slide house"

Notes: Eagle

4 Stork Heron k' a' l u

Halibut x a' g u

Frog k' a' n k u s t a n - on bed-
dress

Cumshewa people:

Charles ^{Wesley} ~~Wesley~~ young fellow. They call him Cumshewa
now. His family (mo, bros etc) are the
only Cumshewa family

Remnants

Nobody here knows anything about the place.

~~st~~ n x d' n g w a y - seal name

n o' n s t o n s - chief

n a x l g a' l s - house name of chief
"half of a house"

Band council would have to be discussed with

Asst Waleon - Chief councillor

George Young

Berta Brown - Mr Brown's wife

~~Jimmy Jones~~

~~Over ^{mission} Cumshewa pole was on y i' l d a g
house.~~

Story from father of bro who saw that man - was
his uncle gāndux | xātga (nickname)
gāndux's father

I don't know real beginning. He got his power
from Heaven, from one of prophets who died
bef Jesus came. One day when a big sickness
came. He made all Inds dance, used his
power, try to save them (she sang his song).
They want him to go to sleep. People said no
he might not wake up. He did one time.
There was long cedar bark. he marked lines
across with Ind paint. "Betw these is one
hour" Nobody knew "hour". built little
tent inside house. Lay down inside. Burnt
end of cedar bark - burnt along slowly. Told
people he was going away someday hours when
to wake him up. Asleep. His master coming
down. Took man inside his coat pocket. He
had bicycle, got on, started step on it
went up to top of qā'nqu Is. ... listed.
His master crying - says Indian not live
long, going to die. Step on it again
(pedal?) - reached Heaven. By wall right
around big city, one big colored man looking

after gate (never seen col man before)
[He had told people 6 days then Saturday.
On Sat have bath wash hair - (nobody
knew Sat). Sunday, never touch a thing
(nobody knew Sunday)]

Reached gate. Col man - had big gun in
hand - old HB gun. flored end. Couldn't let
gun go - hands had grown right around it.
Col man asked Why you smell like Inds.
Ans: "cause I went around where Inds are"
(small man in pocket) Man looked down saw
no will on path - just tent where he slept
nothing else - Means all Inds all over going
he finished - move to one place - Has come
tree. Let him in. There's a big lake
burning. had people burning on there, but
never die. crying. Has that. Just bef
he went up one man died at Tano - had grey
spit on black clouds & rainbows - saw him
there - real suffering.
Master look him up to place
[sāko-y-wit - his Master, the Prophet who gave man power
one of masters named Billy too. His W singing
song.]

Monday June 28 - 1954

Janos Housefront.

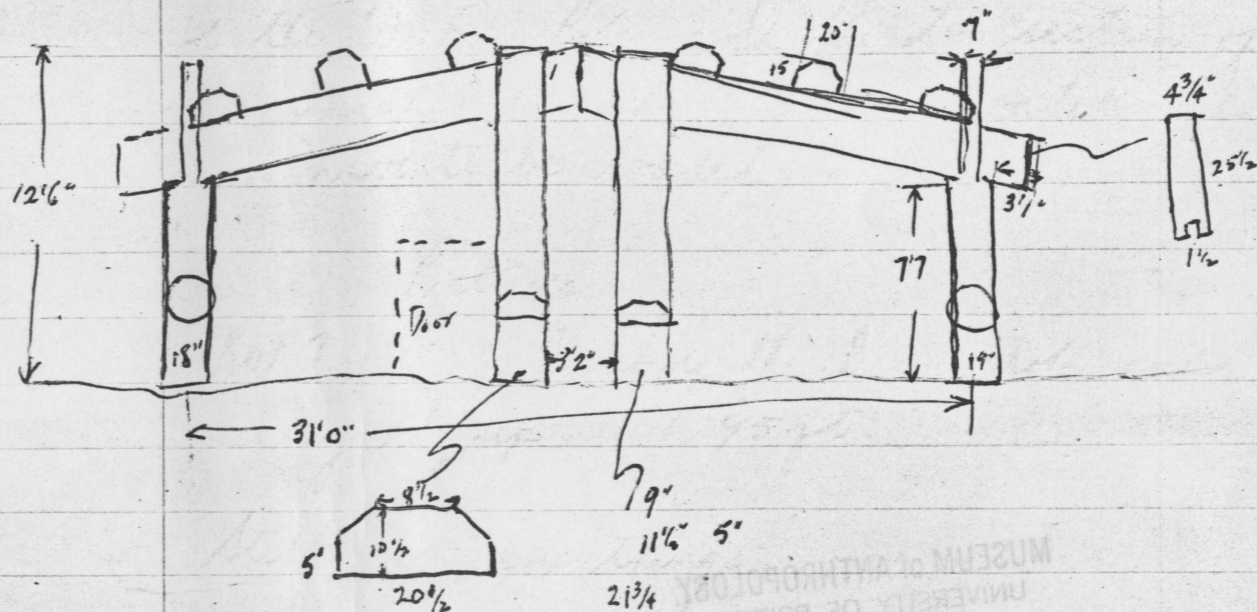

Beams project 3'0". Big ends to front.
 Door usually on left side (Jf.)

syaxaw - beams.

Ka't gadil ay - wall planks

Ʒig'Ʒay

Ʒo'Ʒaw Ʒaw
 Ʒul'Ʒig'Ʒay

Ki'm Ʒaw

Ki'm Ʒaw

Saw God s a n e y i t a y d a s
 great men in heaven

 power
s d n s t a ' n a j w a y
the strange air master

real cheny, cant look at him - Master took
him out of pocket where he lived. Told
Indian "You see, if I give you power
I didd five times - each time time he took
something (clothes) off, hung it up. 5
suits hung there. Reason he told him was
because he (Ind) was going to die.

When he woke up, he told all about that
After that went to Victoria. There's a big
tough granite rock on his house. Told people
If I die, rock will smash up. (Went to
Victoria) also all clouds around water will be
red. Died in Victoria. Rock smashed up.
All clouds red. They knew he died.

When he made them dance, everybody
swing their hats, sang { hold d d o l d d i t
 s o l d d o l d d i t

That's the song they swing the King's hat on
as to what a white man told fabro in Seattle

// He was a sort of Indian doctor s g a ' g a
but he got power from Heaven.

Arappa comes in - give him pipe to smoke.
Power comes. Arappa - Talks to his master
in O l i ' n o g i t or other language

K i ' l o t a t - mainland people St Simpson
Pounded, ^{drum} tobacco in mortar with stone - mixed with
cooked clamshell - chewed it